



ONE FAITH ONE FAMILY

HOLY FAMILY PARISH CAMPAIGN

1010 35th Street | Galveston, TX 77550

A LETTER FROM
Father Jude

“I love the house
where you live,
O Lord, the place
where your
glory dwells.”
~ Psalm 26:8



Dear Parishioners and Friends of Holy Family,

I am excited to share the wonderful news about our parish capital campaign, **One Faith, One Family**, with you. This campaign effort, begun by the Franciscans, will help us finally move forward with plans for a Parish Life Center, with new parish offices and meeting spaces to be located on the campus of our Holy Family Catholic School. We want to honor those who have gone before us and have sacrificed so much to make it possible for us to utilize our present parish facilities spread across the island and the peninsula. At the same time, we want to envision a great future for the generations of Catholics who will follow us by offering a consolidated, spacious facility for all.

On August 15, 2009, Holy Family Parish became the new parish for all Catholics on Galveston Island and the Bolivar Peninsula. Its founding by Daniel Cardinal DiNardo was a result of the devastation created from Hurricane Ike in September, 2008. Holy Family now serves Catholics who were previously served by St. Mary's Cathedral Basilica Parish, Sacred Heart Parish, St. Patrick Parish, Holy Rosary Parish, Mary, Star of the Sea Parish, Our Mother of Mercy Parish, Reina de la Paz Parish, St. Peter the Apostle Parish, and St. Theresa of Lisieux Parish.

Today, Holy Family Parish comprises Six Churches: St. Mary's Cathedral Basilica, St. Patrick, Sacred Heart, Holy Rosary, Mary Star of the Sea and Our Lady By The Sea. The Catholic community on Galveston Island and Bolivar Peninsula continue to work together to rebuild on the foundation of the rich history and diversity of the predecessor parishes. Holy Family Parish offers the unification of all prior parishes providing Catholics diversity in worship locations, educational and fellowship opportunities. We have all been touched and influenced by the example and dedication of our pioneers in the faith and now we gladly accept the challenge to build for future generations to come.

In this brochure you will read about the master plan for Holy Family parish and its first phase of building a centralized location for our parish offices, meeting spaces and daily Mass chapel. With this information in hand, I ask you to prayerfully consider making a pledge to our **One Faith, One Family** capital campaign. Through our personal sacrifices we will together meet our parish's pressing needs today, honor our faith-filled history and fulfill our Christian responsibility to provide for our future.

Thank you for all your gifts of stewardship to the Lord's work in our parish faith community. United as one Holy Family Parish, let us work together to envision and build a bright future for Catholics who will come to see Holy Family as a beacon of faith on both Galveston Island and Bolivar Peninsula.

Your servant-leader in Christ,

Rev. Jude Ekenedilichukwu Ezuma
Pastor

Our Challenge : Phase 1

On August 15, 2009, Holy Family Parish became the new parish for all Catholics on Galveston Island and the Bolivar Peninsula. The parish's founding by Daniel Cardinal DiNardo was a result of the devastation created from Hurricane Ike in September, 2008. Today, Holy Family Parish comprises Six Churches: St. Mary's Cathedral Basilica, St. Patrick, Sacred Heart, Holy Rosary, Mary Star of the Sea and Our Lady By The Sea. Holy Family Parish offers the unification of all prior parishes providing Catholics diversity in worship locations, educational and fellowship opportunities. The Catholic community on Galveston Island and the Bolivar Peninsula continues to work together to rebuild on the foundation of the rich history and diversity of the predecessor parishes. As we have grown as a family, so have our needs for places of worship and places of gathering.

Today, more than ever, we as Holy Family Parish reflect on our past as we prepare for our future, but alas we lack a true central home. Much like our grandmothers' house or our parents' house, we don't have that common gathering space that is big enough, where we can gather as a family to celebrate our faith and fellowship with one another. Our current parish life center at St. Patrick is grossly inadequate to meet our needs. We need a parish life center that has the capacity to accommodate us all as one Holy Family parish.

In response to this need, the Franciscans who formerly served Holy Family, put together a committee to work on a Master Plan a little over four years ago. That torch has been passed to the new parish leadership and the work of building for our future continues in earnest. Currently, we are faced with many challenges. We continue to lack a central gathering place where we can come together as a parish family and celebrate those special occasions. Our parochial school is in need of upgrades to keep the kids safe and to provide an environment that is one of learning and one that is also enticing to new parents and students who seek a quality catholic education.

After much discernment, several deliberations and consultations, the Master Planning committee determined that the most viable option for a parish gathering space would be one that is also central to our current school property. This will provide a place for us to gather in larger numbers to celebrate parish events, wedding receptions, post funeral gatherings and other events needing more space than we can currently accommodate at the old St. Patrick School.

The Master Planning Committee, after meeting with the Cardinal and receiving his blessings to proceed, discerned that it would be prudent to divide the Master Plan into phases that would be accomplished over a 15-20 year time frame. This allows the parish to accomplish projects in sizes and costs that can be challenging but are achievable in scope.



The first phase of the Master Plan will consist of repairing and renovating the old convent wing of the school to accommodate the parish office and create meeting spaces for the different parish groups.

Phase One – Replace Entire Complex Roof, Renovate Former Convent Wing, & Provide Additional Parking

Roof Replacement

We will first replace and expand the roof of the entire complex so that it provides a reinforced barrier from the elements. This new roof will “claim” two courtyards that will be covered and converted into indoor, climate-controlled meeting spaces.

Meeting Room/Classroom Construction

The first of these former courtyards will be in the center of the new parish administration wing and will become a 2,400 square foot meeting space that will be dividable into as many as four 600 square foot classrooms.

Renovation of the Former Convent to Parish Offices

The convent would be renovated to house offices for the entire Holy Family parish staff including offices for our priests, deacons, music, youth, business office and house all the records of the parish. This wing also features a chapel that will be for parish use.

Parking

In addition, there will be a new parking lot constructed to hold approximately 160 cars.

The estimated cost for Phase I is \$5.5 million.

Cost Estimates

Description	Estimated Cost
Roof Replacement & Expansion	\$700,000
Administration/Convent Renovation	\$2,150,000
Parking Additions & Utilities work	\$2,650,000
Phase I: Project Total:	\$5,500,000

We are blessed to have a vibrant parish community. We are also blessed with so many fabulous and historic places of worship and also the seat of Catholic Education in Texas. With all this in mind, and with the possible addition of a parish center for common gatherings and celebrations, our opportunity abounds.



How to Pledge Your Support

Everyone is asked to prayerfully consider how their generosity can reflect their gratitude for the gifts that God has given them. Each family is asked to consider a pledge of \$5,000 or more, payable over four years. A pledge of \$5,000, after a 10% down payment of \$500, is \$94 per month or \$3.08 per day.

We know that a pledge of \$5,000 will be a challenge for some of our parish households; therefore, it is vital to the success of our campaign that those with greater financial resources consider a larger sacrifice. Individuals who are financially capable of pledging \$10,000, \$25,000, \$50,000, \$100,000 or more are asked to step forward and become leaders of our campaign.

In Deuteronomy 16:10 we are reminded that “the measure of your own free will offering should be in proportion to the blessing the Lord has bestowed on you”.

Our Vision

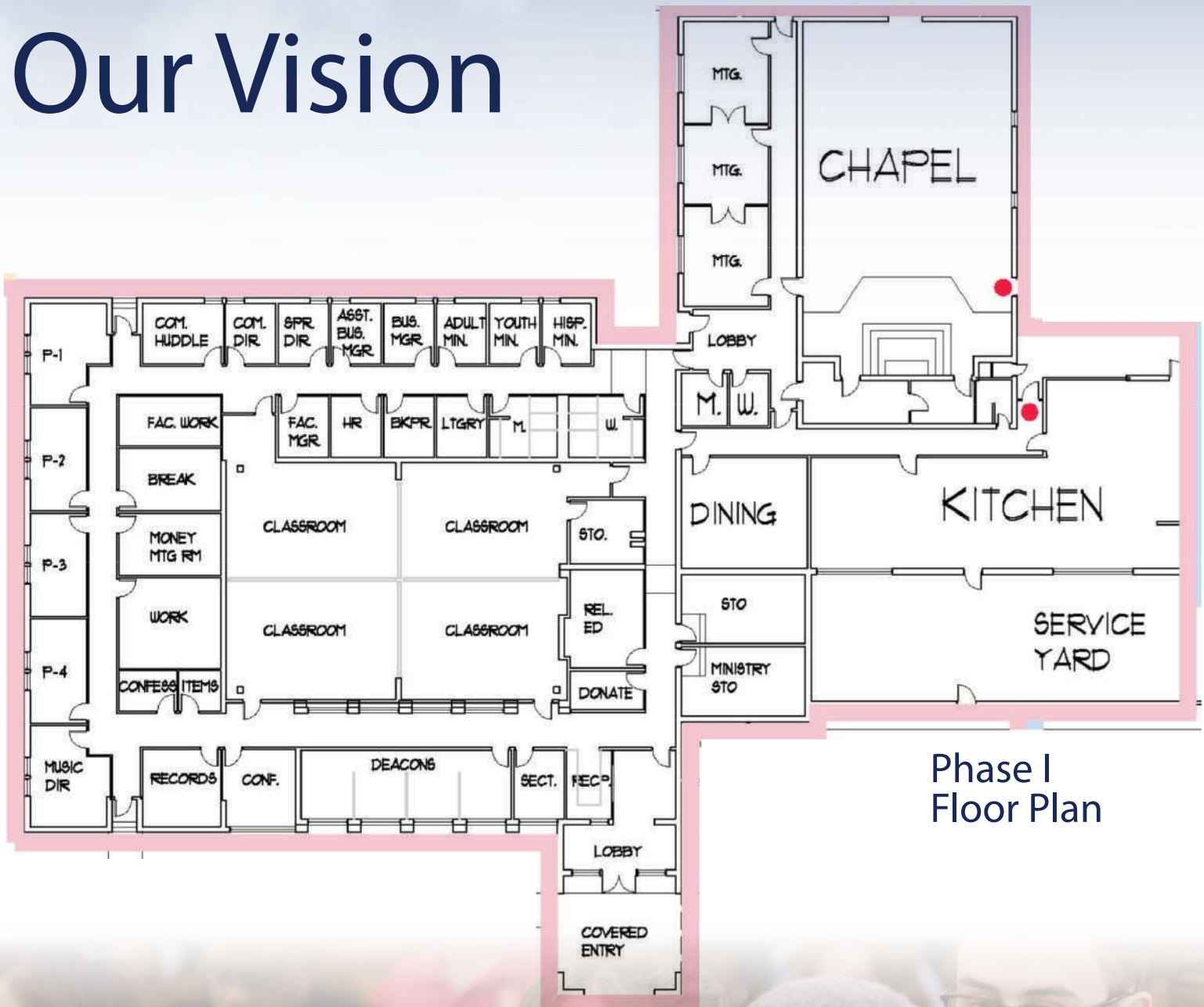

Phase I
Floor Plan



MASTER PLAN | PHASES

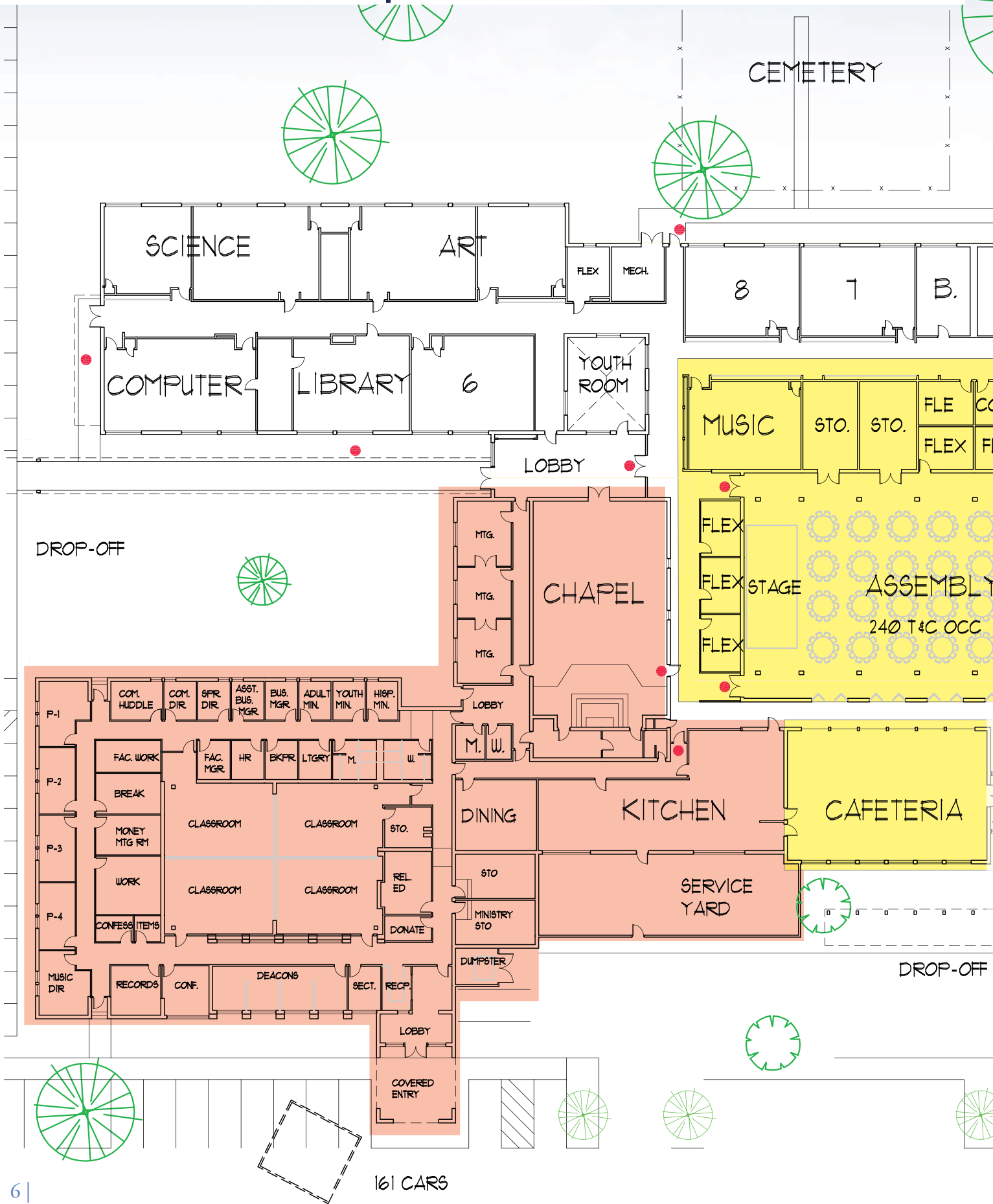



ONE FAITH ONE FAMILY

HOLY FAMILY PARISH CAMPAIGN

SITE PLAN

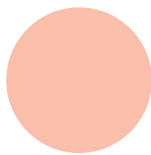

PHASE 1

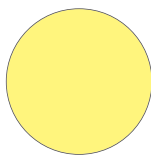

PHASE 2

Our Vision

Before

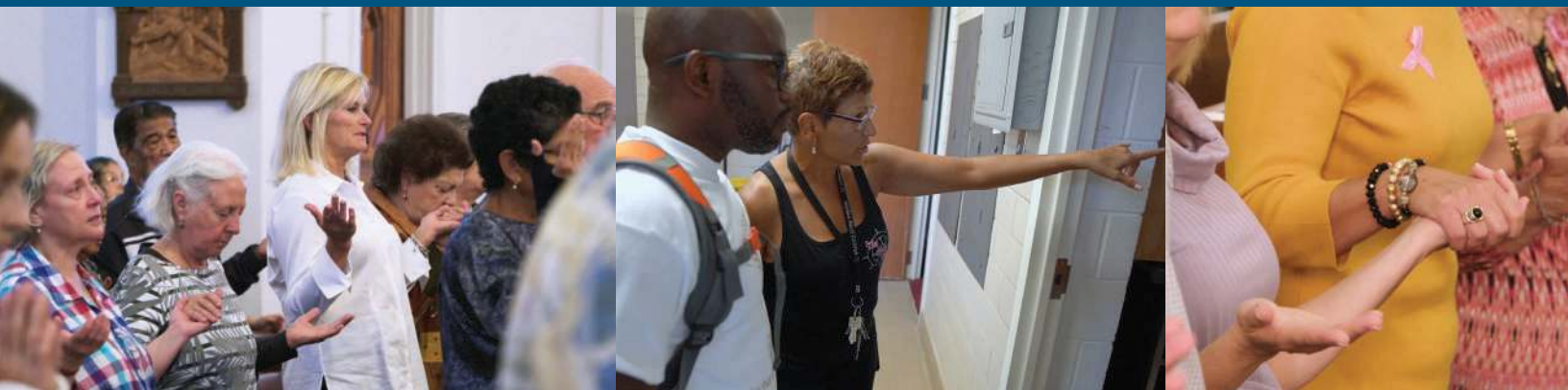

Entrance



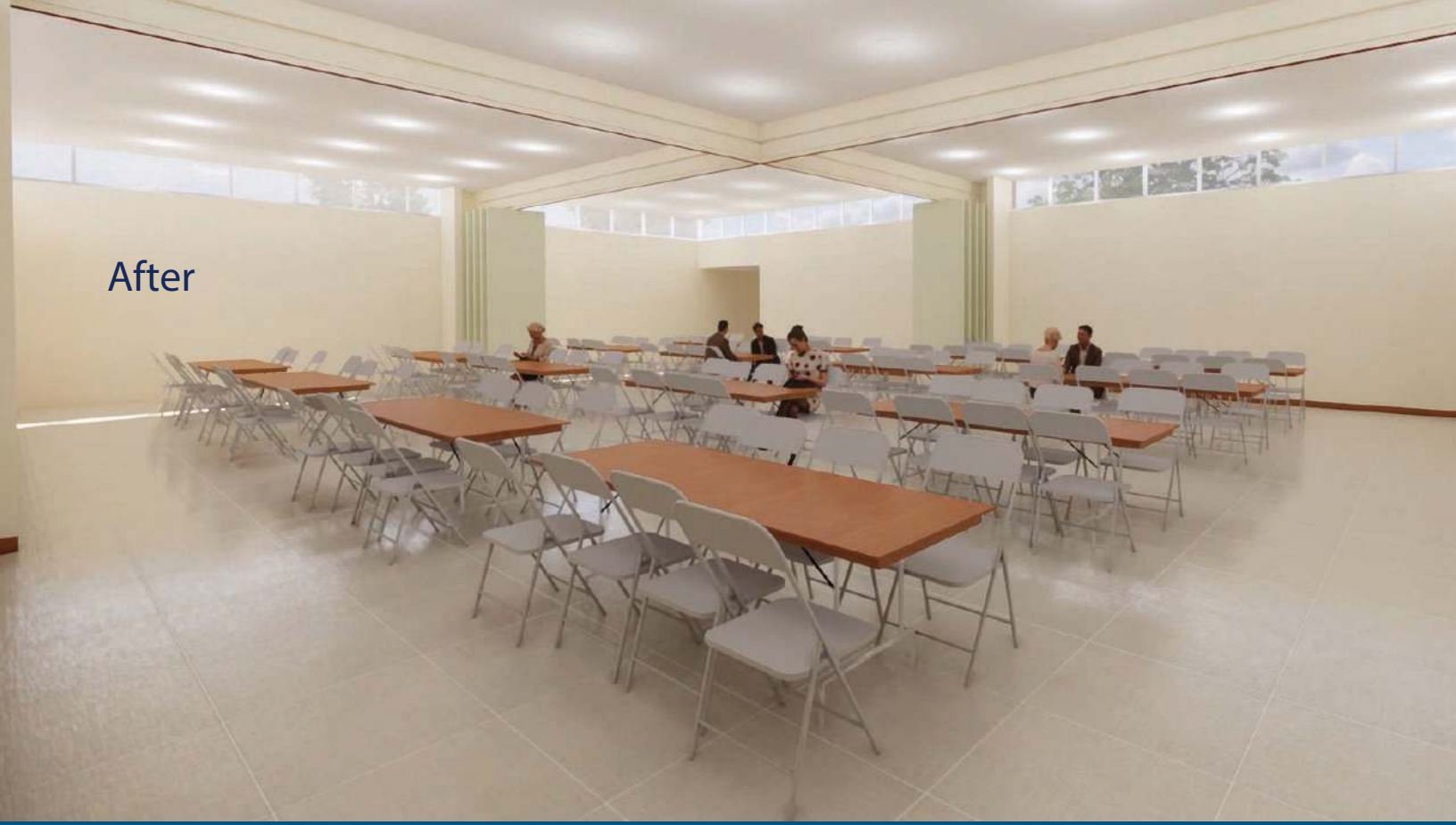

After



Birds Eye View

Suggested Gift Plans

Total Gift	10% Down Payment	4 Annual Payments	8 Semi-Annual Payments	16 Quarterly Payments	48 Monthly Payments	Daily Sacrifice
\$1,000,000	\$100,000	\$225,000	\$112,500	\$56,250	\$18,750	\$616.44
\$500,000	\$50,000	\$112,500	\$56,250	\$28,125	\$9,375	\$308.22
\$250,000	\$25,000	\$56,250	\$28,125	\$14,063	\$4,688	\$154.11
\$100,000	\$10,000	\$22,500	\$11,250	\$5,625	\$1,875	\$61.64
\$75,000	\$7,500	\$16,875	\$8,438	\$4,219	\$1,406	\$46.23
\$50,000	\$5,000	\$11,250	\$5,625	\$2,813	\$938	\$30.82
\$25,000	\$2,500	\$5,625	\$2,813	\$1,406	\$469	\$15.41
\$10,000	\$1,000	\$2,250	\$1,125	\$563	\$188	\$6.16
\$7,500	\$750	\$1,688	\$844	\$422	\$141	\$4.62
\$5,000	\$500	\$1,125	\$563	\$281	\$94	\$3.08

The gift plans in this brochure are provided as a suggested guideline when considering your pledge. Please review the gift plans carefully and select one that fits your household's financial ability. Payment amounts are calculated assuming a 10% down payment for each pledge.

AS YOU MAKE YOUR PLEDGE, PLEASE REMEMBER...

- Make checks payable to **Holy Family Parish**. Please write "**Capital Campaign**" in the memo field.
- All donations made to this campaign will be deposited into the capital campaign fund and will be used exclusively for the case items presented in this brochure.
- Payments can be made over a period of four years or longer, if necessary.
- All contributions to the campaign are fully tax deductible for those who itemize their taxes.
- Pledge payments are in addition to your regular offertory. The Sunday offertory collection pays for the day-to-day operations of the parish, while your pledge in this campaign will be used specifically for capital campaign case items.
- Pledges are not legally binding, but rather an indication of your intention to donate.

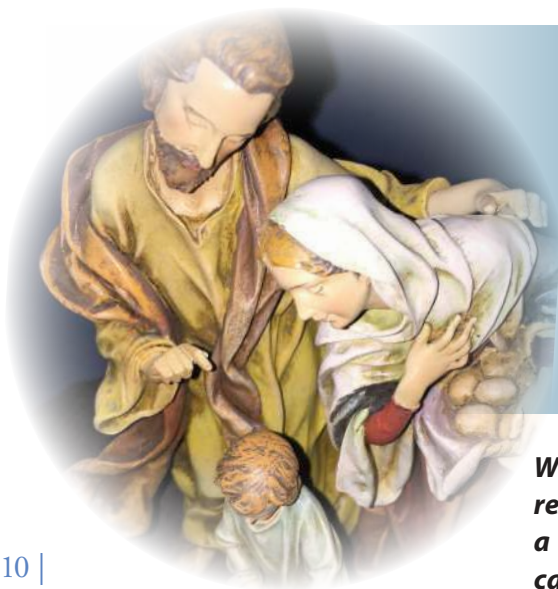

Not everyone can make the same size gift; but everyone can make an equal sacrifice.

Whether you participate by attending a campaign reception, responding at Mass or by mail, or by graciously receiving a visit from a fellow parishioner, it is your active involvement that will make this campaign a success.

Giving Options

Pledges Via Cash, Check or Online Giving

Simply complete your pledge card by selecting the amount of your pledge and down payment (optional, but encouraged). Make sure to select your method of payment, i.e., monthly, quarterly, semi-annual or annual payments. Please make checks payable to **Holy Family Parish** and please write "**Capital Campaign**" in the memo line. You will be mailed payment reminders and a special payment envelope in accordance with the payment plan you choose. Once completed, please return your pledge card in the weekly collection, bring it by the parish office or return it in the mail. To make your gift online please visit <https://giving.parishsoft.com/app/giving/hfp> or **scan this qr code at bottom of this page.**

Gifts Of Stock

Donors can use their own broker/agent to transfer stock. If the stock has been held long-term (over one year), the donor does not have to pay capital gains tax on the stock, and is allowed a tax deduction for the full value of the stock. Donors may also choose to sell stock in order to claim a loss, which may be beneficial for tax circumstances. In either case, the stock must first be transferred to the parish before being liquidated. Please contact the campaign office for more information.

Gifts of Property, Life Insurance, Annuities, Wills or Bequests

There are different ways to support Holy Family Parish both today and in the years to come via planned giving. Families or individuals can make gifts of real estate, personal property, automobiles, life insurance, estate bequests, annuities or charitable remainder trusts. For substantial gifts of property other than marketable securities, the IRS requires an appraisal. Please contact the campaign office for more information.

Gifts From Retirement Accounts

The IRA Charitable Rollover provision of the 2015 PATH (Protecting Americans from Tax Hikes) Act permits individuals age 72 or older to contribute up to \$100,000 from a qualifying retirement account directly to a qualifying charity without recognizing the assets transferred to the charity as income. Please contact your financial advisor for additional information concerning gifts via retirement accounts.

Federal and state laws on income and inheritance taxes encourage charitable giving. It may be particularly advantageous for some people to contribute stocks, appreciated securities, annuities, property, or other valuables. In many cases, the tax savings may be more than your original investment in the gift. Because each situation is unique, we urge you to discuss such donations with a financial advisor.

To make your gift online you
can scan this QR Code



If you have any questions about the campaign or making your pledge, please contact the parish office at 409-762-9646.





O God,

giver of all good gifts, we thank you for all your blessings. We beg you to look graciously upon our efforts to continue the work of building a united and faith-filled one Holy Family Parish through our capital campaign – **One Faith, One Family**. May your Holy Spirit fill us with wisdom, courage, cooperation and generosity as we work toward reaching our campaign goals.

Mary, our Mother, you show us by your example that when we make great sacrifices, trusting in God's will for us, we are made abundantly fruitful. Pray for us your children so that following your example, we may prayerfully contribute to the success of our capital campaign to build a one Holy Family Parish, united in the joy of the Holy Spirit. We ask this through Christ our Lord.

~AMEN

Many people contribute to the life of our parish and provide vision for our future. Our deepest gratitude extends to the members of the Campaign Committee, who have given the gifts of their time and talents to make this project a success. And, of course, we could not have been able to reach out to everyone in our parish family if it weren't for the help of our gracious and very dedicated volunteers.

THANK YOU!

FUNDRAISING CONSULTANT
Guidance In Giving, Inc.
Stewardship, Development
& Campaign Consultants
www.guidanceingiving.com

For more information, view our campaign overview video at:
https://youtu.be/ca_yZL9RFto
or scan the QR Code

